

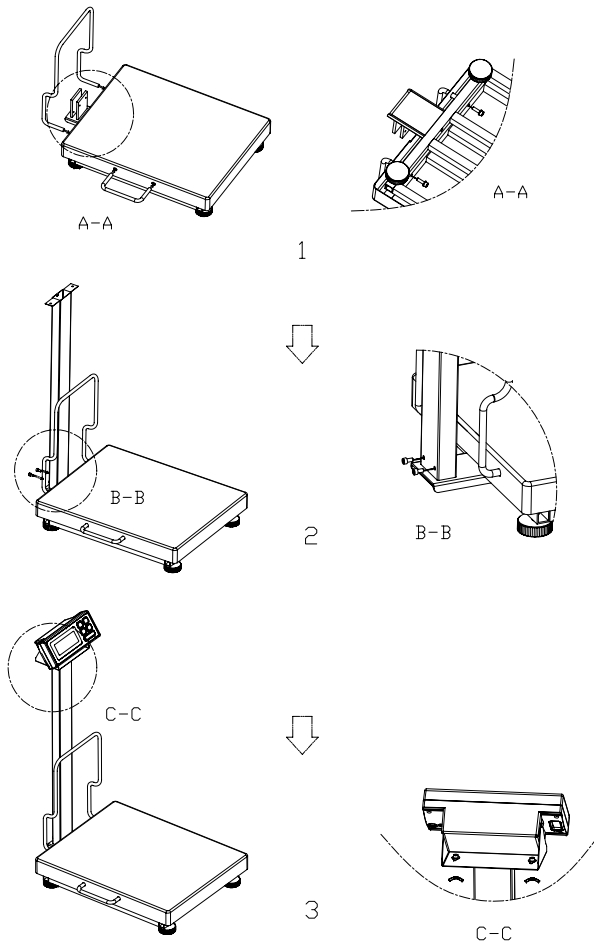

## PS-B Series

# INSTRUCTION MANUAL



Step 1 :As shown in figure A-A , fix the rail on the upper bracket with two socket head screws.

Step 2 : As shown in figure B-B , fix the stainless steel rectangular tube on base of the lower bracket with two socket head screws.

Step 3 : As shown in figure C-C , fix the indicator on the stainless steel rectangular tube with two socket head screws 、 two washers and two butterfly nuts .

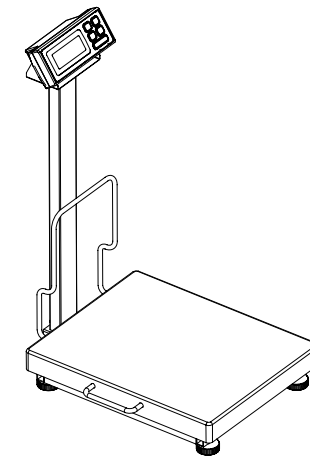

## KEY DESCRIPTIONS :

<b>ON/OFF</b>	<b>HOLD</b>
<b>UNIT</b>	<b>ZERO</b>
<b>PRINT</b>	

- 1. ON/OFF:**  
Turn the scale power on/off.
- 2. HOLD:**  
A. Press this key to store weight value.
- 3. UNIT :**  
A. Select weigh units : kg or lb .
- 4. ZERO :**  
This key is “Zero” feature if load is below 4% of full capacity or a negative value. between 4% and 50% is tare function
- 5. PRINT:**  
Press once and send weight information once.

## Work mode setting of the indicator:

1. press and hold [UNIT] key and [HOLD] key, then press [ON/OFF] key to turn on the scale, the display will show Ani.Sw, press [UNIT] key to enter function setting menu ,press [ZERO] key to select ON or OFF ( ON means animal mode, OFF means normal weighing mode),press [HOLD] key to confirm the selection.
2. press [HOLD] key again to enter the next menu, the display will show Ani.Kd, press [UNIT] key to enter function setting menu, press [ZERO] key to select animal scale anti-shock range among 50, 100, 200, 400, press [HOLD] key to confirm the selection.
3. press [HOLD] key again to enter the next menu, the display will show Ani.fd, press [UNIT] key to enter function setting menu,press [ZERO] key to select animal scale fliter range among 0.5, 3, 5, 10, press [HOLD] key to confirm the selection.
4. press [HOLD] key again to enter the next menu, the display will show Ani.Ft, press [UNIT] key to enter function setting menu,press [ZERO] key to select animal scale flister time among 1,2,3,4,press [HOLD] key to confirm the selection

## FUNCTION SETTINGS

Press and hold [HOLD] key then press [ON/OFF] key to turn on the sclae, the display will show A-ON or A-OFF, press [ZERO] key to select on or off (ON means auto power off function activate, off means auto power off function inactivate). Press [UNIT] key, the display will show L-ON or L-OFF, press [ZERO] key to select on or off ( ON means auto backlight function activate, OFF means auto backlight function inactivate).

Press UNIT key, the display will show P-XX. Press ZERO key to select OFF, key, con and Stb.( OFF means RS232 function inactivate, KEY means that output the data by pressing [PRINT] key. Con means that output the data continually. Stb means that output the data when reading is stable)

Press UNIT key, the display will show J-ON or J-OFF, press ZERO key to select ON or OFF. (ON means showing zero when turn on the power, OFF means showing weight placed when turn on the power.)

## Features :

1. Display options : 5 digital LCD
2. Power : AC adapter 10V 500mA
3. Auto back light (selectable)
4. Auto shut off (selectable)
5. Operating Temperature : 5 ~ 35°C
6. Operating Humidity : 25% ~ 95%RH
7. 5 Keys : ON/OFF, ZERO, UNIT, HOLD, PRINT
  - ZERO** This key is “Zero” feature if load is below 4% of full capacity or a negative value
  - UNIT** Toggle among KG or LB unit
  - ON/OFF** Turn the scale power on/off
  - HOLD** Press this key to store weight value
  - PRINT** Press once and send weigh information once.
10. Zero Range (4% to full capacity)
11. Tare Range (50% to full capacity)
12. Error Message indication :
  - Err-0** Ovrload
  - Err-2** Exceed zero track range when power on
  - Err-5** Unstable when power on
  - Err-c** Calibration code is not enough or operation error.
  - Low** Low battery indication
13. Two calibration weight units : kg , lb.
14. Open calibration capacity
15. Power on zero-setting range:  $\pm 10\%$
16. Zero range:  $\pm 4\%$  of full capacity
17. Three modes : Normal mode / Setting mode /Internal Auto Calibration mode
19. RS232 function

## When to calibrate

Calibration may be required when it is initially installed, if the scale/balance is moved to a substantial distance.

This is necessary because the weight of a mass in one location is not necessarily the same in another location. Also, with time and use, mechanical deviations may occur.

### Calibration Weight

press and hold [ZERO] key then press [ON/OFF] key, the display will show CAPU=, press [UNIT] key to select full capacity unit kg or lb, press [HOLD] key to confirm the selection. press [HOLD] key again to enter the next menu, the display will show CAP, press [UNIT] key to enter setting full capacity, press [UNIT] key to move the flash digit to right, press [ZERO] key to increase the flash digit, press [HOLD] key to confirm the selection. Press [HOLD] key again to enter the next menu, the display will show CALU=, press [UNIT] key to select calibration unit kg or lb, press [HOLD] key to confirm the selection. press [HOLD] key again to enter the next menu, the display will show CAL, press [UNIT] key to enter setting calibration weight ,press [UNIT] key to move the flash digit to right, press [ZERO] key to increase the flash digit, press [HOLD] key to confirm the selection ( the calibration weight should be more than 2/3 of full capacity). press [HOLD] key again to enter the next menu, the display will show DIV, press [UNIT] key to select division, press [HOLD] key to confirm the selection. press [HOLD] key again to enter the next menu, the display will show ADC, press [UNIT] key to select 18,press [HOLD] key, and then display will show CAL.

Press [PRINT] key, the display will show CAL,then AD value, press [UNIT] key when the stable indicator lights. the display will show flash calibration weight, place the shown weight on the platform, press [UNIT] key when the stable indicator lights, the display will show ----, AD value. Turn off the scale now, calibration is finished.

Turn on the scale, place tested weight to check whether it is correct, if not, please repeat above segments.

interface :

1 : signal interface : ( microphone socket )

Red-----→E+ ( positive source )

Yellow-----→S+ ( positive signal )

Black-----→E- ( negative source )

White-----→S- ( negative signal )

No sign -----→GND

2 : Rechargeable battery socket :

AC/DC 10V-----external positive, inner negative

3 : RS232 interface : DB9

RS232 TRANSMIT FUNCTION

1. RS232 Transmission Agreement :

- Mode : Simplex Asynchronous Serial
- Baud rate : 9600
- Data Bit : 8
- Parity Bit : NONE
- Stop Bit : 1
- Data Format : ASCII

2. Transmission Information Format : 20 Byte , blank=20H

HOLD FUNCTION

- 1) Place the item on the scale platform.
- 2) Wait for the stable weights to be displayed.
- 3) Press theHOLD key. The “.” hold indicator will turn-on.
- 4) Remove the item from the scale platform. The item’s weight reading will remain on the display. Now you can also select unit (ie to Pounds or Kilograms) by pressing **【UNIT】** key.
- 5) Quit HOLD function: Once an item is weighed and the hold function is enabled; you want to quit HOLD function, Press the HOLD key again to cancel the “.” hold indicator and return the scale to weight mode.

**M= overload mode**  
**W= normal weighing mode**

**: = weight information**

1	2	3	4	5	6	7	8	9	10	11	12	13	14	15	16	17	18	19	20
W/M	:	±																CR	LF

**Weight information**      **Unit formation**

**Example:50kg**

1	2	3	4	5	6	7	8	9	10	11	12	13	14	15	16	17	18	19	20
W	:	+							5	0	.	0	k	g				CR	LF